



Beaufort

User Manual

Avola, Licota, Ricardo, Basso

Soho & Belmonte

Monte Maschio & Donne

Content



General Information	3
Introduction	4
Characteristics	7
The 800U LCD display / Models Avola, Licota, Ricardo & Basso.....	8
The mid-drive comodo / Models Monte Maschio & Monte Donne...	12
The Soho comodo / Model Soho.....	17
Taking out the battery.....	18
Security en comfort.....	18
Starting your E-bike.....	19
Lights.....	19
How to drive	20
Store / Park.....	20
How to fold / Model Basso	21
Maintenance and service.....	25



General Information



• In order to enjoy your bike safely we suggest you to go through this manual.

Adjust your speed on slippery roads and take into account that the braking path is longer when it snows or rains.

• This electrical bicycle works fine when it rains or snows, but avoid extensive contact with water. (e.g. high pressure cleaner)

• Never directly connect the positive and negative battery pole. This leads to electrical breakdown and heavy damage. Consult Veloci if you want replace or adjust parts.

• Don't lend your bicycle to individuals who don't know how to ride with an e-bike.

• Most batteries are sensitive to temperature. The battery will perform better on warm days. While the battery capacity can decrease with 1/3th when the temperature is under the freezing point. So it's normal that the number of km's ridden with a full battery can be lower during the winter. When the temperature reaches above 15 degrees the capacity of the battery will restore itself.

• When you don't use your bicycle for a longer period (3 months or more), than it's appropriate to disconnect the battery. This in order to protect the lifetime of the battery.

• If the bike is parked, stored in a cold place than it's appropriate to disconnect the battery and store it in a place with room temperature.

Introduction



Our electrical bicycles are designed with an eye for maximum comfort and high-quality finishing touch. Great care was spent on the selection of qualitative parts and simple controls. So you can enjoy the ride in all safety with support from the electric motor.

The design is based on a classical city bike, with the addition of a motor under the crankshaft or in the front wheel (depending on the model); a rotation sensor on the crankshaft, a smart battery in the luggage carrier and a display located on the steering wheel.

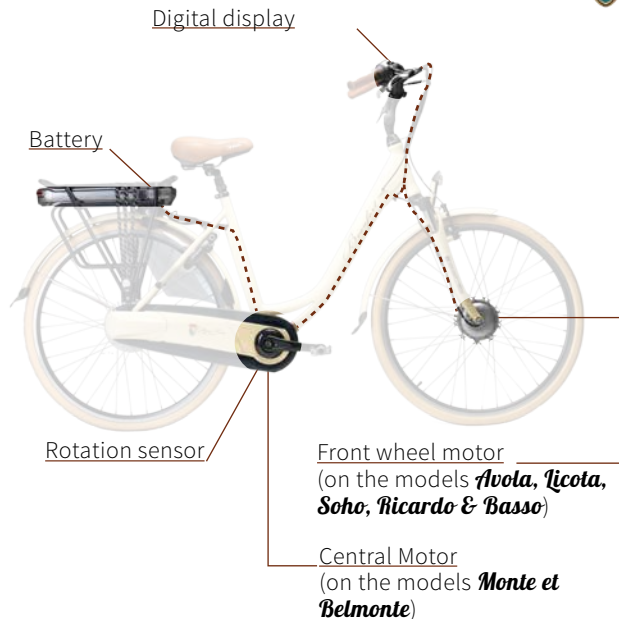

GENERAL TECHNICAL PARAMETERS

GENERAL TECHNICAL PARAMETERS	
Measurements (lxlxh)	
Avola, Monte, Ricardo, Licota, Belmonte	1900x650x1200mm
Basso	1740x600x1100mm
Weight	
Avola, Monte, Ricardo, Licota, Belmonte	≤25kg
Basso	≤20kg
Max speed	≤25km/hrs
Carrying capacity	≤120kg
Distance entre le centre de la avant et arrière	
Avola, Monte, Ricardo, Licota, Belmonte	1135 ± 5mm
Basso	1050 ± 5mm
Range with full battery	60 km to 140 km*
Energy consumption per 100 km	1.2kw.h

* Standard conditions: new battery, temperature of 25°C, flat and dry road surface, few slopes, assistance level 1-3, weight of the driver 75 kg, few start and stops.

CHARGE PARAMETERS

CHARGE PARAMETERS	
Charging time	4 à 6 hours
AC power	AC220V/60Hz
Max output	60W

CONTROLLER PARAMETERS	
Low voltage	31.5±1V
Overcurrent protection	15±1A

MOTOR PARAMETERS	
Motor Type	
Avola, Monte, Ricardo, Licota, Soho	Moteur Brushless DC
Monte	Bafang Max Drive system – Central Motor
Belmonte	Shimano DU-E6001 – Central Motor
Power Belmonte	420 Wh
Power Licota, Monte, Soho, Basso	468 Wh
Power Avola, Ricardo	522 Wh
Voltage	36V
Efficiency	> 75%
Efficiency Monte	> 80%

BATTERY PARAMETERS	
Battery type	Li-ion LG
Capacity Belmonte	11,6 Ah
Capacity Licota, Monte, Soho, Basso	13 Ah
Capacity Avola, Ricardo	14,5 Ah
Voltage	36V

Characteristics



- When creating the 3D-design high quality materials, ergonomics and esthetical characteristics were taken into account. Which results in high riding comfort.
- The frame is made from high-quality aluminum, that guarantees a low weight linked with sustainability.
- Qualitative V-brakes in front and back for optimal braking force.
- The support of the electric motor inactivates when a higher speed than 25km/h is reached, in accordance with the European law concerning electrical supported bicycles. There's no need to take out an extra insurance to legally ride with this bicycle on the road.
- The range depends on different factors such as the tire pressure, changes in the terrain, weight of the driver and the amount of support. For this reason it's common to control the tire pressure regularly.



The 800U LCD display / Models Avola, Licota, Ricardo & Basso



FEATURES

- Two-way serial communication, 5-way button, very easy to operate.
- Speed display: AVG SPEED, MAX SPEED, real time SPEED.
- Kilometer / Mile : Can be set according to customers' habits.
- Smart battery indicator : Provide a reliable battery indicator, it will not fluctuate with the motor on/off.
- Automatic headlamps & background light : 800U can automatically open/close the headlamps & backlight according to the external light.
- Buzzer remind : Built-in buzzer, sound alert in multi-state, such as Key tone / Low temperature warning / Low battery indicator / Failure warning...
- Temperature display : Indicate ambient temperature, indication range is -20°C~50°C, higher than 50°C will display HI, lower than -20°C will display Lo.
- Maintain remind : 800U can indicate the maintain information according to the battery cycle times and the riding mileage(ODO). 800U can estimated the battery cycle life.
- Low temperature warning : 800U can alarm the user by LCD&BUZZER when the temperature is below freezing.
- The brightness of the backlight adjustable : 5-sections

- 9-level PAS : 3-PAS/5-PAS/9-PAS optional
- Power indicator : Real-time battery output power indication
- Mileage indicator : Trip distance/ Odometer / DST/Riding time
- Error code indicator
- Parameter settings : Multiple parameter can be set through computer USB port, including PAS level / Wheel diameter / Voltage / Speed limit / Magnetic steel / Number of halls...

The LCD display Description:

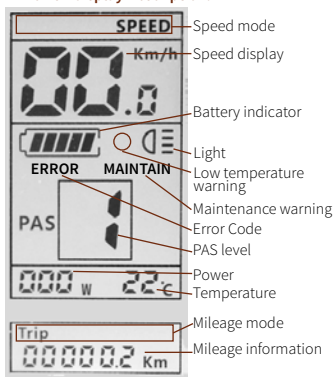

Presentation

- SPEED : current driving speed
- AVG : average driving speed
- MAX : maximal speed
- TRIP : trip distance in Km/Mile
- ODO : total distance / Mileage
- Time : trip time

Functional description:

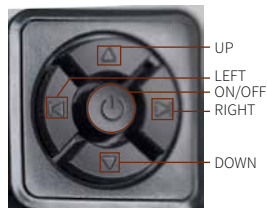

1 Power On/Off

Press and hold Power button for 1 second can turn on/off the display. The Display can automatically shut down when there is no operate & ride for X minutes. (X could be 0~9).

2 Assist level operating

Short press UP/DOWN button can change the assist level. Top assist level is 9, 0 for neutral. Level quantities can be adjusted according to the customer requirements.

3 Speed mode switch

Short press LEFT button can change the speed mode, Speed->AVG Speed->MAX Speed.

Note: If there is no operation for 5 seconds, the display will return Speed (Real-Time) display automatically.

4 Mileage mode switch

Short press RIGHT button can change the mileage mode, Trip->ODO->DST->Time. Remaining mileage (DST) was calculated through riding status and remaining capacity, this value is dynamically adjusted according to the riding state.

5 Headlight/backlight On/Off

Press and hold UP button for 1 second can turn on/off the headlight/backlight.

Note: The motor does not work when the battery voltage is low, Display still can keep the headlight on for a while when E-bike is in riding.

Note: At the automatic light sensor mode, press and hold the UP button can turn on the backlight / headlights. If automatic light sensor had opened the backlight / headlight, press and hold the UP button can not turn it off. First you should turn off the automatic sensor mode in display settings, and then turn off the light manually.

6 Walk

Press and hold DOWN button for 1 second can get into walk mode, out of the mode when release the button.

7 Battery indicator

Provides a reliable battery indicator. When

the battery indicator shows under voltage, the battery needs to be charged.

8 Data cleanup

Press and hold RIGHT button together for 1 second can reset several temporary data, temporary data include AVG Speed / MAX Speed / Trip / Time.

PARAMETER SETTING

Double press POWER button (press interval less than 0.3 second) can get into parameter setting state, the current parameter flashing, short press UP/DOWN buttons to set the parameter values, short press LEFT/RIGHT buttons to switch the parameters, short press POWER button to exit the parameter setting state. The display will automatically exit the parameter setting state when there is no operation for 10 seconds. The order of parameters is as follows.

1 Kilometer / Mile : The location of speed displays symbol S7, press UP/DOWN button rotate display the symbol km/h / MPH (Km / Mile)

2 Kilometer/Mile : the location of speed display symbol CF, press UP/DOWN button rotate display the symbol Km / MPH

3 Light sensitive : The location of speed display symbol bL0, press UP/DOWN button display symbol 0~5 , 0 indicate automatic headlight/backlight OFF. 1~5 indicate automatic headlight/backlight ON. 1 indicates the brightest on (auto turn on the backlight at bright environment), 5 indicates the darkest on (auto turn on the backlight at dark environment).

4 Backlight brightness : The location of speed displays symbol bL1, press UP/DOWN button display symbol 1~5 to change the brightness of the backlight.

5 Buzzer on/off : The location of speed display symbol bEP, press UP/DOWN button rotate display symbol 0/1, 0 indicates buzzer off, 1 indicates buzzer on.

6 Auto off time : The location of speed displays symbol OFF, press UP/DOWN button to change the value from 1 to 9, the number represent delay time (minutes) before display shutdown automatically, default value is 5 minutes.

7 Power display : The location of speed display symbol Pod, press UP/DOWN button display symbol 0/1, represent whether to show the power indicate on LCD.

8 Maintain remind : The location of speed display symbol nA(ma), press UP/DOWN button rotate display symbol 0/1, 0 represent maintain reminding off, 1 represent maintain reminding on.

9 Wheel diameter : The location of speed displays symbol Wd, press UP/DOWN button rotate display the symbol 16/18/20/22/24/26/700C/28/27.5/29, value represents the diameter of the wheel (inch). Wrong value for wheel diameter will cause speed&mileage abnormal.

10 Voltage set : The location of speed displays symbol bU0, press UP/DOWN button rotate display the symbol 24V/36V/48V/UbE, UbE means user-defined voltage setting, this parameter can be set through computer.

11 Password/Speed limit set : The location of speed display symbol PSd, remind to input passwords, press UP/DOWN buttons to setup password value (0~9), press LEFT/RIGHT buttons to switch the password item, password is 4 digits, the default password is "1919". Press POWER button when password adjustment is completed. Display will return to the Voltage set item if the password is incorrect. Correct password will enter the Speed limit set item.

12 Speed limit set : The location of speed displays symbol SPL, the location of mileage displays speed limit value, the default value is 25km/h. Press UP/DOWN buttons to modify the value, the value can be set from 10 to 41km/h. Press RIGHT button to enter the next item.

Note: The maximum speed is restrict by the motor and controller, probably couldn't reach the setting value.

13 Magnetic Pole numbers of speed sensor: The location of speed displays symbol HAL, the location of mileage displays magnetic pole number, the default value is 1, press UP/DOWN buttons to modify the value, the value can be set from 1 to 15.

14 Direction of speed sensor: The location of speed displays symbol ASd, press UP/DOWN button rotate display symbol 0/1, 0 indicates forward, 1 indicates backward.

15 Over a few grains of magnet start: The location of speed displays symbol SAd, the location of mileage displays pole number, press UP/DOWN buttons to modify the value.

16 Assist proportion: The location of speed displays symbol SAR, the location of mileage displays assist proportion value, press UP/DOWN buttons to modify the value.

17 Throttle set: The location of speed displays symbol HAd, press UP/DOWN button display symbol 0~1 to change the throttle OFF or ON.

18 Throttle 6KM set: The location of speed displays symbol HAR, press UP/DOWN button display symbol 0~1 to change the throttle 6km OFF or ON.

19 Slow startup parameters: The location of speed displays symbol Sdr, the location of mileage displays value, press UP/DOWN button to modify the value.

20 MAX Current set: The location of speed displays symbol CUL, the location of mileage displays current limit value, the default value is 15A. Press UP/DOWN button to modify the value.

21 Range of assist level setting: The location of speed displays symbol PAS, the location of mileage displays assist range, the default is UBE. Press UP/DOWN button to change the value from 0-3 to UBE.

22 Battery Pack Temperature: The location of speed displays symbol ETE, the location of mileage displays the temperature of the battery pack. Unit: °C.

23 Battery Pack Voltage: The location of speed displays symbol bSU, the location of mileage displays the voltage of the battery pack. Unit: mV.

24 Real-time current: The location of speed

displays symbol CUr, the location of mileage displays real-time current value. Unit: mA.

25 Percentage of relative capacity: The location of speed displays symbol rCP, the location of mileage displays percentage of relative capacity value. Unit: %.

26 Absolute Percent Capacity: The location of speed displays symbol ACP, the location of mileage displays absolute percent capacity value. Unit: %.

27 Remaining Capacity: The location of speed displays symbol SCA, the location of mileage displays remaining capacity value. Unit: mAh.

28 Full Capacity: The location of speed displays symbol FCA, the location of mileage displays full capacity value. Unit: mAh.

29 Battery cycle times: The location of speed displays symbol CYC, the location of mileage displays the cycle value. Unit: times.

30 The current charging interval: The location of speed displays symbol PCH, the location of mileage displays the current charging interval value. Unit: hr.

31 Maximum charge time interval: The location of speed displays symbol bCH, the location of mileage displays the maximum charge time interval value. Unit: hr.

MAINTAINANCE REMINDER

(This function is optional)
The display can remind maintainance information according to mileage (ODO) and battery cycle times.

1 display will display symbol MAINTAIN when the ODO accumulated more than setting mileage (this parameter can be set by dealers), the mileage symbol will flash for 4 seconds when the display power on, the buzzer beep for 2 seconds at the same time.

2 Display will display symbol MAINTAIN When the battery cycle over setting times, the symbol of battery will flash for 4 seconds when the display power on, the buzzer beep for 2 seconds at the same time.

You can shutdown maintain reminding message by parameter setting. Parameter setting / Maintain reminded / MA / 0

ERROR CODE DEFINITIONS

800U can give a warning message when the E-bike encounters an error. The LCD displays the ERROR icon and the error code in speed position. Error codes go from 01 E to 07 E, the definitions are explained in the table below:

Error Code	Description	Action
0x 21	Current abnormal	
0 x 22	Turn error	Check turn to connect.
0 x 23	Motor phase lost	
0 x 24	Hall error	Check the hall connection
0 x 25	Brake error	Check the brake connection.
0 x 30	Controller communication error	
0 x 31	Battery communication error	

ELECTRICAL PARAMETERS

24V/36V/48V battery supply
Rated operating current : 10mA
Max operating current : 30mA
Off leakage current < 1uA
Max output current to controller : 50mA
Operating temperature : -30°C to 70°C
Storage temperature : -40°C to 70°C

PRECAUTIONS

1. The display is waterproof but may not be immersed in water completely
2. Do not leave the display in full sunlight when not using it
3. Check the communication between display and controller on a regular basis
4. Do not disassemble units by yourself.
5. Do not use thinner, alcohol or fuel to clean the display or other electrical units.
6. Concentrate on the road and not on the display while driving. Safety first!

The mid-drive comodo / Models Monte Maschio & Monte Donne



FUNCTION OVERVIEW

- Use of a two-way serial communication protocol, simple operation of the display via the external 5-key keypad.
- Speed display: displaying the real-time speed as SPEED, the maximum speed as MAXS and the average speed as AVG.
- km or mile: The user can choose between km and mile.
- Intelligent battery level indication: With an optimization algorithm, a stable display of the battery level is ensured, and the problem of fluctuant battery level indication common with other displays is avoided.
- Automatic light-sensitive lights: The headlight, taillight and display light will be automatically turned on/off depending on lighting conditions.
- 5 levels off display backlighting: Different levels
- 5-Level-Support: setting power Levels 1 to 5
- Trip distance indication: The maximum distance displayed is 99999. Single-trip distances TRIP or the total distance TOTAL can be displayed.
- Display of error messages
- Walk assistance
- Settings: Various parameters, e.g. mode, wheel diameter, speed limit etc., can be set on the computer

via a communication cable. See the setting

- Maintenance warning (this function can be deactivated):

Maintenance warning information is displayed based on battery charge cycles and riding distance. The display automatically estimates the battery life and gives warnings when the number of charge cycles exceeds the set value. A warning will also be displayed when the accumulated total riding distance exceeds the set value.

INFORMATION ON THE DISPLAY

- A) Maintenance warning: When there is a need for maintenance the symbol SERVICE will be displayed (riding distance or the number of battery charge cycles exceed the set value, function can be deactivated)
- B) Menu
- C) Speed display: display of the speed, km/h or mph
- D) Speed mode: average speed (AVG km/h), maximum speed (MAXS km/h)

- E) Error display: When a fault is detected the symbol will be displayed.
- F) Distance indication: display of the distance depending on the setting.
- G) Level indication: The chosen level 1–5 will be displayed; if there is no numeric display, it means that there is no assistance (by the motor). If the rider is walking and pushing the e-bike, "WALK" will be displayed.
- H) Walk assistance

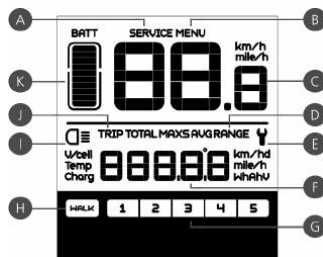

I) Headlight indication: only shows when headlight or backlight are on

J) Distance mode: display of the single-trip distance TRIP and the total distance TOTAL

K) Battery level: 10-segment battery indication; the voltage that each segment represents can be customized

KEY DEFINITIONS

- A) up (+)
B) down (-)
C) headlight
D) on/off
E) mode



NORMAL OPERATION

1 On/Off Switch

Turn on the device. Press and hold for 2 seconds to power on the display. Press and hold again for 2 seconds to power off the display. If the bike is not used, after 5 minutes (time can be set) the display will be automatically turned off.

2 Assist Mode Selection

In the manual gearshift mode, press the + or - to choose the desired level of support by the motor. The lowest level is Level 1, the highest Level 5. When the display is on, the default mode is Level 1. When there is no numeric mode display, there is no power assistance.

3 Switch between Distance Mode and Speed Mode

Briefly press i to switch between distance and speed. Single-trip distance (TRIP km) / total distance (TOTAL km) / maximum speed (MAXS km/h) / average riding speed (AVG km/h) are displayed in successive order.

4 Headlight/ Display Backlight Switch

Press for 2 seconds. The backlight of the display as well as the headlight and taillight will be turned on. Press again for 2 seconds to power off the display backlight/headlight/taillight. (If the display is turned on in a dark environment, the display backlight/ headlight/

taillight will be turned on automatically. If the display backlight/headlight/taillight are turned off manually, they also need to be turned on manually afterwards). There are 5 levels of backlight brightness that can be selected by the user.

5 Walk Assistance

Press - for 2 seconds. The e-bike enters the walk assistance mode, and the symbol WALK is displayed. Once the key - is released, the e-bike will exit the walk assistance mode.

6 Battery Status Indication

When the battery status is normal, a certain number of the battery LCD segments as well as the border light up according to the actual quantity of charge. If all of the 10 segments will black out with the border blinking, the battery needs to be charged immediately.



PARAMETER SETTING

1 Items to be Set:

- 1 Data reset
- 2 km/mile
- 3 Light sensitivity
- 4 Display backlight brightness
- 5 Automatic off time
- 6 Maintenance warning settings
- 7 Input of the password
- 8 Wheel diameter selection
- 9 Setting speed limit

2 Setting Preparation

When the display is active, press **i** twice (interval < 0.3 seconds). The system will enter the MENU parameter setting state, in which the display parameters can be set. Press **i** twice again (interval < 0.3 seconds) to return to the main menu.

In the parameter setting state, when the parameter you want to set begins to flash, press **/** to adjust the parameter value. Briefly press to switch between the parameters to be set. Press twice (interval < 0.3 seconds) to exit the submenu. If no operation is performed for 10 seconds, the display will return to the normal riding display.

3 Data Reset

Press **i** twice (interval < 0.3 seconds) – the dis-

play enters the MENU state. In the speed field **tC** is displayed. If you press **+**, **y** is also displayed. Now all temporary data, e.g. maximum speed (MAXS), average speed (AVG) and single-trip distance (TRIP) can be cleared. Briefly press (< 0.3 seconds) to enter the km/mile setting interface.

If the user does not reset the data, the single trip distance and the accumulated total riding time will be automatically cleared when the accumulated total riding time exceeds 99 hours and 59 minutes.

Note: The data will not be cleared when the display's lightsensing

function is set to 0 or when it is switched off.

4 km/mile

When the speed field displays **S7**, press **+/-** to switch between km/h and mph, or to set km or mile.

After this setting, briefly press **i** (< 0.3 seconds) to enter the setting interface of light sensitivity.

5 Light Sensitivity

When the speed field displays **bL0**, use **+/-** to choose a figure between 0 and 5. The higher the chosen figure, the higher the light sensitivity.

After this setting, briefly press **i** (< 0.3 seconds) to enter the setting interface of backlight brightness.

6 Display Backlight Brightness

When the speed field displays **bL1**, press **+/-** to choose a figure between 1 and 5. The figure 1 represents the lowest brightness while 5 indicates the highest display backlight brightness.

After this setting, briefly press **i** (< 0.3 seconds) to enter the setting interface of automatic off time.

7 Automatic Off Time

When the speed field displays **OFF**, press **+/-** to choose a figure between 1 and 9. The figures indicate the minutes that it takes to automatically shut down the display.

After this setting, briefly press **i** (< 0.3 seconds) to enter the setting interface of maintenance warning.

8 Maintenance Warning (can be deactivated)

When the speed field displays **nnA**, press **+/-** to choose either 0 or 1. 0 disables the function while 1 enables it.

After this setting, briefly press (< 0.3 seconds) to enter the setting interface of password input.

The display will prompt maintenance necessity based on such information as the accumulated riding distance and the battery charge cycles.

• When the accumulated total riding distance exceeds 5,000 km (can be customized by the manufacturer), the display will show the symbol

. When **SERVICE** the display is started up, the sign for accumulated riding distance will flash for 4 seconds, indicating that maintenance is necessary.

• When the number of battery charge cycles exceeds 100 (can be customized by the manufacturer), the display will the symbol **SERVICE**. When the display is started up, the sign for battery will flash for 4 seconds, indicating that maintenance is necessary.

• The maintenance alert function can be disabled: settings / maintenance alert (MA) / maintenance alert (MA) / 0. (Maintenance alert can also be set via a computer. This requires a USB connection. See also the parameter setting instructions).

9 Further Settings: Password Setting

When the speed field displays **PSd**, it is a prompt to enter a password. Press **+/-** to set the four-figure password (using digits 0 to 9). Briefly press **i** to

switch between the single digits of the password. The default password is "0512". Briefly press to switch between the single digits of the password. The default password is "0512". Briefly press **i** to confirm your setting. If the set password is wrong, the system automatically returns to the previous interface. If the set password is

correct, the system will switch to the setting of the wheel diameter.

10 Wheel Diameter Selection

When the speed position displays **Wd**, press **+/-** to select the correct wheel diameter: 16/18/20/22/24/26, 700c, 28/29. The measurements are in inches. A wrong wheel diameter can lead to speed anomalies. After this setting, briefly press (< 0.3 seconds) to enter the setting interface of speed limit.

11 Speed Limit Setting

When the speed field displays **SPL**, the distance field displays the value of the speed limit. Press **+/- i** (< 0.3 seconds) to enter the menu of battery communication.

12 Battery Communication

The speed field displays **b01** and the distance field displays the speed limit. Press **i** (< 0.3 seconds) to see the other information in sequence. After this setting, press **i** twice (< 0.3 seconds) to exit the menu.

Note: Only when communication has been established between the battery and the controller the following information will be displayed, otherwise the display will only show " - - -".

13 Information on the battery menu

Left column: Information Displayed in the Speed Field; Right column: Explanation

b01	current temperature
b02	maximum temperature
b03	lowest temperature
b04	total voltage
b05	current
b06	average current
b07	remaining capacity
b08	full capacity
b09	relative state of charge
b10	absolute state of charge
b11	charge/discharge cycle
b12	longest period without charge
b13	period since last charge
d01	voltage cell 1
d02	voltage cell 2
dn	voltage cell n

ERROR CODE DEFINITIONS

The MAX-C966 display can show e-bike faults. When a fault is detected, the icon  will be displayed. In the speed field one of the following error codes will be displayed:

Error Code	Description	Troubleshooting method
"03"	Brake enabled	Check whether a brake cable is stuck
"04"	The throttle has not returned home	Check if throttle has returned home
"05"	Throttle fault	Check the throttle
"06"	Low voltage protection	Check the battery voltage
"07"	Overvoltage protection	Check the battery voltage
"08"	Motor hall signal cable fault	Check the motor module
"09"	Motor phase cable fault	Check the motor module
"11"	Controller temperature sensor failure	Check the controller
"12"	Current sensor failure	Check the controller
"13"	Battery temperature fault	Check the battery
"21"	Speed sensor fault	Check installation position of speed sensor
"22"	BMS communication fault	Replace the battery
"30"	Communication fault	Check the controller connection

The Soho Comodo / Model Soho



FUNCTIONS

1. On off
2. Assistance level up (+)
3. Assistance level down (-)
4. Indicator for the level of assistance
5. Battery level indicator

NORMAL OPERATION :

POWER ON /OFF : push this button for 2 seconds until the assistance level indicator shows the first level of assistance.

Note: The commands will shut down automatically after a few minutes when the bicycle is not moving.

Choosing the level of assistance

To augment the level of assistance (1-3) press the (+) button. To diminish the level of assistance press the (-) button

The battery indicator

When the battery level indicator shows 4 leds, the battery is full, when it shows only one led or none at all, it is time to charge the battery.

Lights

The front light must be turned on/off manually with a button on top of the front lamp. The tail light is turns on automatically as soon as it gets dark.



Taking out the battery

The battery can be disconnected if necessary, but the battery can also be charged while its attached to the bicycle. Open the lock on luggage carrier and take the battery out. After loading put the battery back and secure the lock.

Lock



Security en comfort

Please check the following items before using your e-bike:

- Check if the brakes are fully operational
- Check the tire pressure
- Set the handlebar in a comfortable and safe seating position.



Starting your E-bike

- Set the saddle height on a comfortable height. The saddle is set on the right height when the bike driver is sitting on the bike with a stretched leg and the heel of the driver is on the pedal the moment the pedal is at its lowest position.
- Turn on the display by pushing the ON/OFF key



Lights

All models have rear lights that turn on automatically according to external light. All front lights work on AA batteries and need to be turned on and off manually.



How to drive

- The motor will start to work automatically after 2 or 3 rounds of pedals. To extend the lifespan of your battery, we recommend to start the bike up in assistance level 1 or 2, and to gradually augment the assistance level while driving.
- By using the gear control in the right handlebar, it is possible to shift gears. In order to extend the lifespan of your battery, we recommend to use these gears when starting your e-bike.
- The motor will deactivate as soon as the driver stops pedaling. Do not forget however that the motor will keep working for about 1 second after the driver has stopped pedaling.
- The battery will deactivate as soon as it is empty. When you deactivate the electrical assistance you will be able to continue your journey without assistance.
- The assistance will deactivate automatically as soon as your velocity exceeds 25 km/h.
- The luggage carrier supports a maximum weight of 15 kg

Store / Park

- Always lock the bicycle, if possible foresee an extra lock.
- Also lock the battery to prevent theft.
- When the bicycle is stored for a longer period of time then it's important to load the battery every three months. If this doesn't happen then the battery will be irrevocably damaged, thus the warranty expires.

How to fold / Model *Basso*

Put the saddle in the lowest position by unlocking the lever (1). Unlock the lever (2) and bend the top part of the handlebar sideways. Unlock the central lever (3) on the frame and fold the bicycle in half.



Instructions for charging the battery

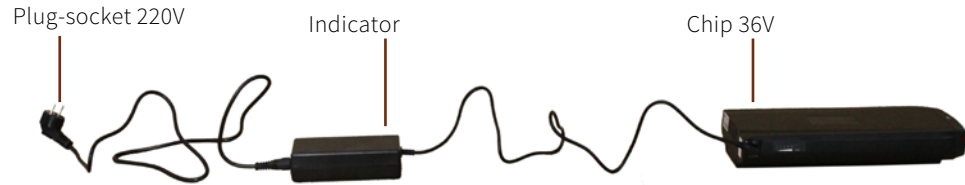

a. It's really important to first connect the charger to the battery, and then put in the plug into the plug-socket. Turning around this way of working can heavily damage the battery.

b. When the indicator on the charger turns red, is the loading successfully started.

c. In case of loading the battery separated from the bicycle, then it's important that battery rests on even ground.

d. The battery needs to be loaded for at least 14h when using the bike for the first time.

e. When the charging is completed the indicator will turn green.

f. It's really important that after the loading that the plug is disconnected from the 220V plug-socket and then disconnect the charger and the battery.

Instructions for charging the battery



g. There are 5 active LED's on the battery. Push POWER to check the remaining capacity.
- A full battery shows 4 out of 5 lights.
- Three green lights: the battery is full for 75%.
- Two green lights: the battery is half full.
- One red light: the battery is empty.

h. The battery is fully loaded when the indicator on the charger turns green (4 to 6 hours). Then starts the drop loading process, you can keep the charger connected to the battery until you use the e-bike again.

i. The charger has an overcurrent protection, but to avoid damage it's appropriate to disconnect the charger within 24h.

j. The battery needs be charged as much as possible. When the bicycle is stored for a longer period of time then it's important to load the battery every three months. If this doesn't happen then the battery will be irrevocably damaged, thus the warranty expires.

Instructions for charging the battery

Safety Regulations

- Keep children out of range of the battery and charger.
- ONLY use the charger received on delivery.
- Do not open the charger, there's a high voltage circuit on the inside.
- Do not drop the charger and avoid contact with water.
- Do not cover the charger while loading.
- Only use the charger in a dry and well ventilated space.



Maintenance and service

- Check if the bolts of the front-and back wheel are strongly screwed on.
- Check if there's no leeway on the crankshaft and ball head.
- Review condition of the tires, control tread and search for tears. Check tire pressure.
- Tighten mucks and bolts around the whole bicycle
- Control brake blocks for wear and tear
When the battery isn't used for a longer period of time then it will empty itself. Please try to foresee that you fully charge the battery again before using the bicycle.
- Charge the battery every three months to avoid irrevocable damage.
- Regularly clean the bicycle and lubricate the chain, definitely after a ride in the rain. Don't use a high pressure cleaner.
- Yearly maintenance by Veloci is advised in order to keep your bicycle in top condition.
- You can use the Bizbike service card in case of a breakdown with your e-bike. There's also a touring card available which is delivered together with the bicycle. Yearly maintenance is advised but this doesn't have an influence on the warranty.



Beaufort

